

2 1/2" STAINLESS STEEL ROUND TUBE HEADACHE RACK

With Optional Light Bar (Part #645) and Optional Side Rails (Part #531 & #532)

1. Stainless Steel Collar
2. Saddle
3. Rubber Washer
4. Bolt 5/16" x 3"
5. Saddle with Half Cut & Thread Expander
6. End Plug
7. Light Tab
8. Stainless Steel Collar for #639 Only!
9. Stainless Steel Acorn Nut
10. Threaded Rod
11. Universal Foot
12. Saddle with Threaded Expander
13. Bolt 5/16" x 1"
14. Side Rail 6" or 8" (Part #531 & #532)
15. Bottom Tube for Headache Rack
16. Main Loop for Headache Rack
17. Light Bar (Part #645)

BOLT KIT CONTENTS

- 6 - Self Tapping Screws
- 4" x 1" Bolts
- 1/4" Nylon Insert Lock Nuts
- 8 - 1/4" Washers

Instructions for Universal Feet on All Stainless Headache Racks

Place Headache Rack on truck center and make sure front of foot is close to the front edge. **(Check to make sure the HAR is not touching the cab of the truck.)**

After placement is checked, mark the front outside hole and the back inside hole. Drill a 1/4" hole for the bolts supplied.

Check underneath to make sure there is no obstruction.)

Put HAR on truck and align holes. Put bolts through, apply washers and lock nuts (hand tighten). Check again for center and be sure it is not touching the cab.

Tighten bolts and use self tapping screws in the inside front hole and the outside back hole.

Make sure all bolts are tight.

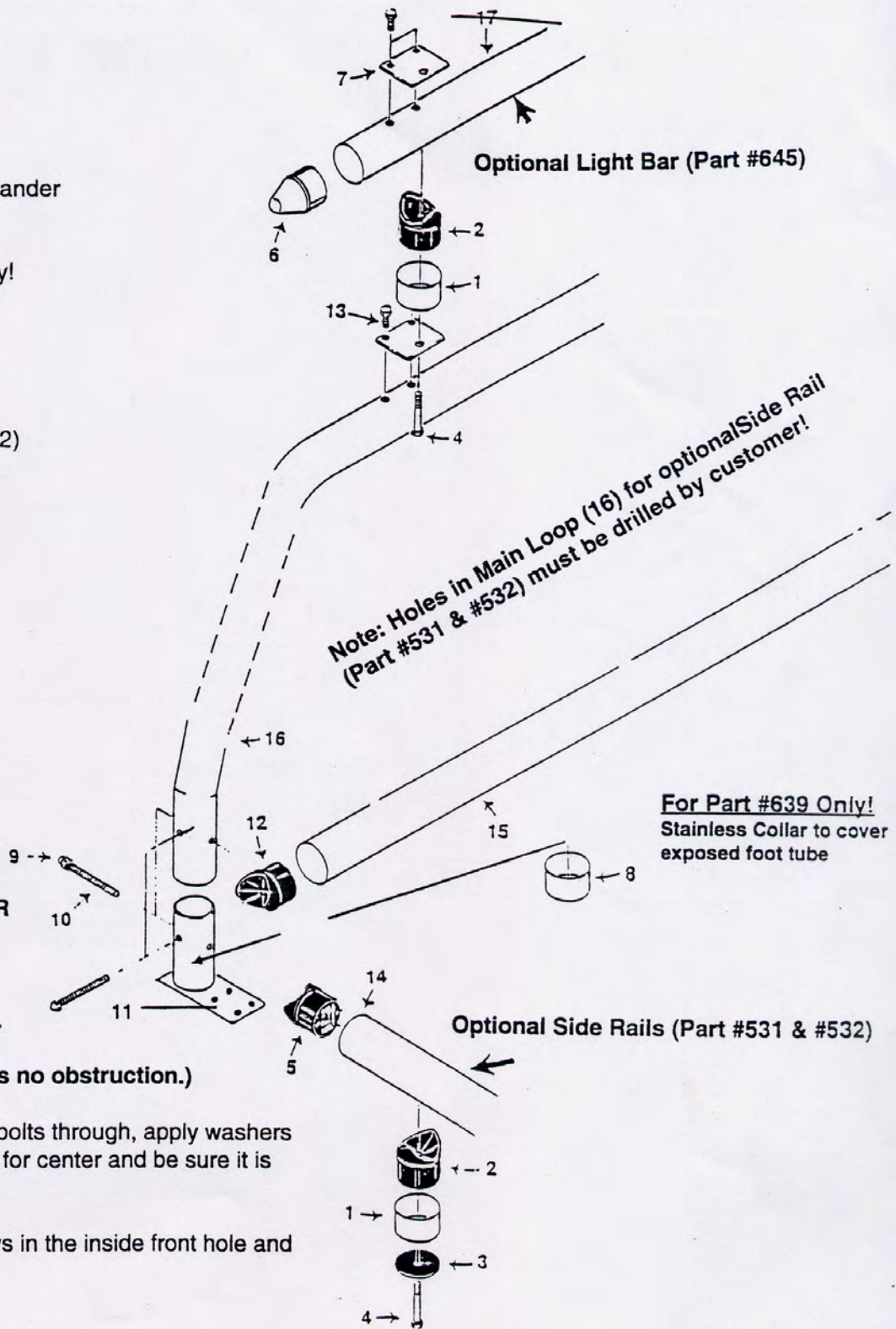

Note: Holes in Main Loop (16) for optional Side Rail (Part #531 & #532) must be drilled by customer!

For Part #639 Only!
Stainless Collar to cover exposed foot tube